

Oil-injected screw compressor stage

EU 30(III) Series

Air end data

power consumption at

driving shaft recommended [kW] **30**

volume flow max [m³/min] **5.85**

discharge pressure max. [bar a] **15**

male rotor speed max. [rpm] **6,083**

lobe combination **4/5**

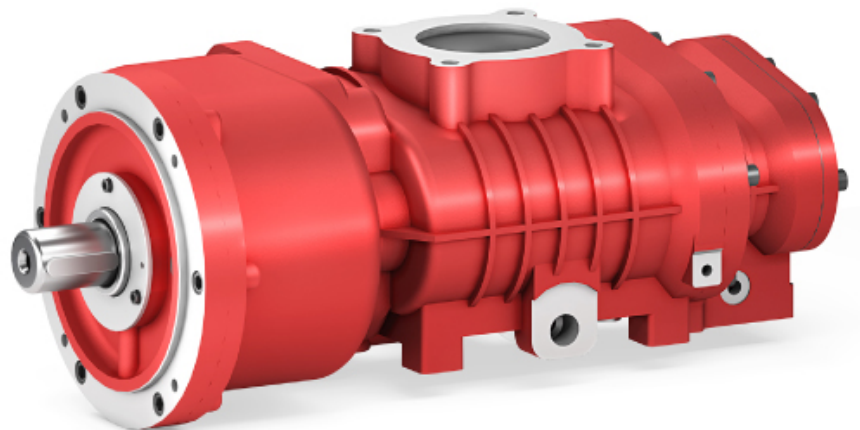
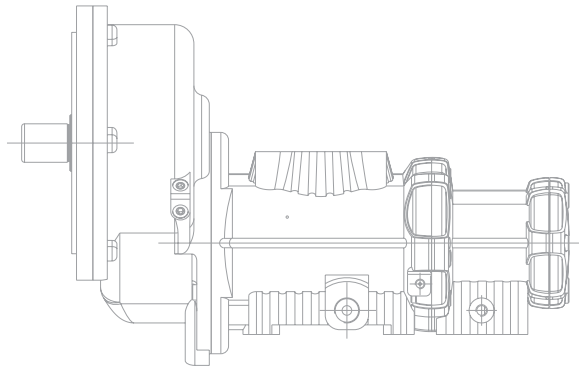
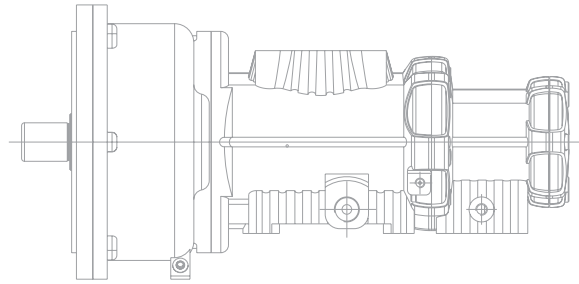

EU 30(III) Series

Performance data

Performance statements according to ISO 1217

Oil injected screw compressor air end EU30(III)
male rotor tip speed(m/s)

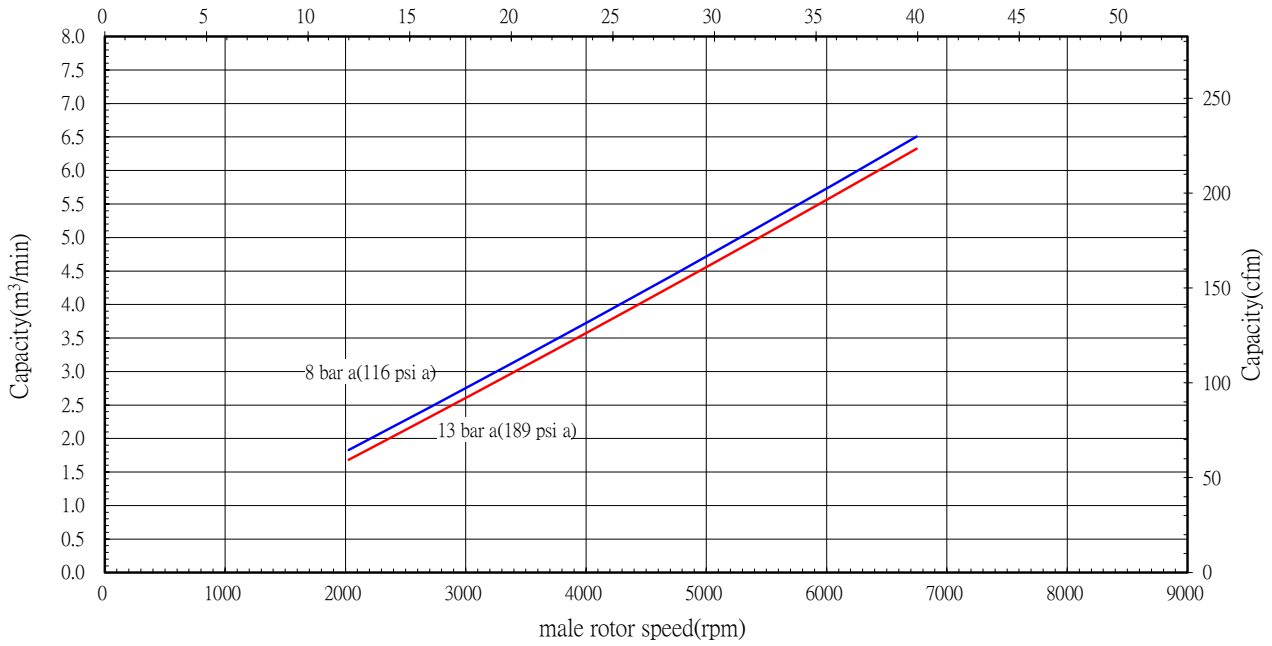

Oil injected screw compressor air end EU30(III)

male rotor tip speed(m/s)

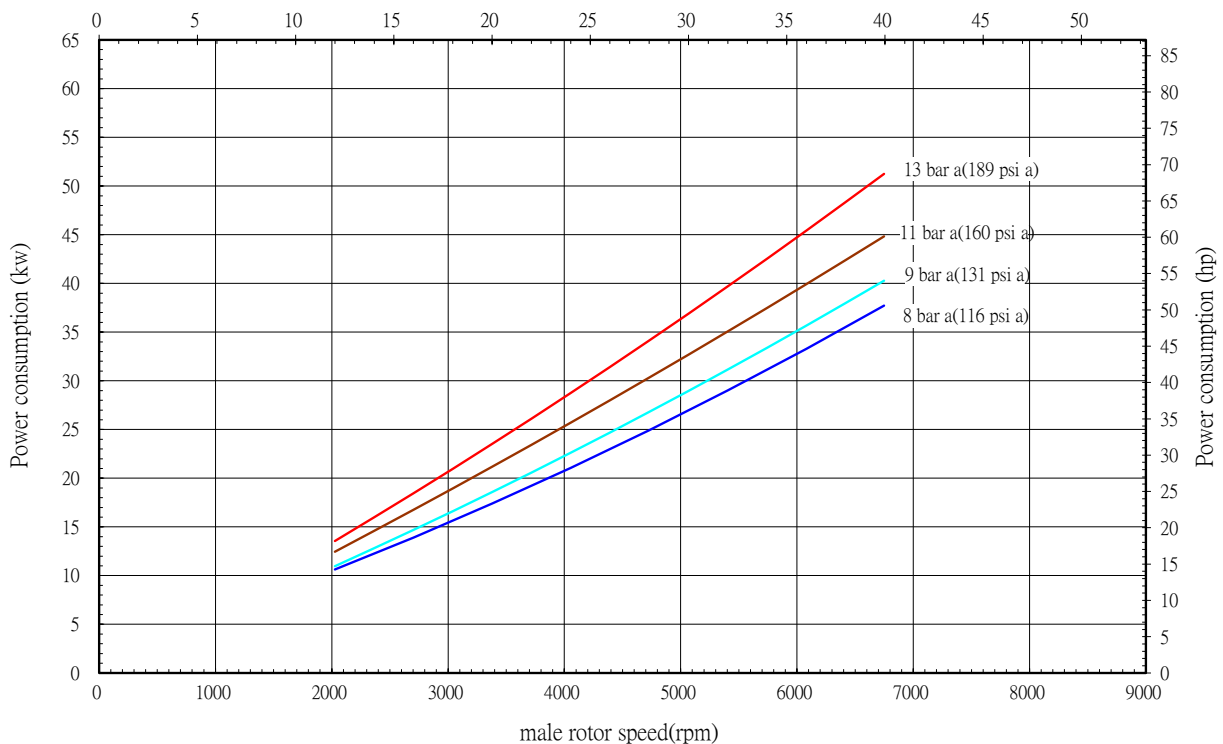

Oil-injected screw compressor stage

EU 30(III)

Installation drawing [mm]

weight [kg]

53.3

